

Reg. No.

**MANIPAL UNIVERSITY**

**SECOND SEMESTER B. DES. (ID) DEGREE EXAMINATION – MAY 2016**

**SUBJECT: BID 104 – GRAPHICS FOR INTERIORS – 3 DIMENSION  
(2015 SCHEME)**

Tuesday, May 24, 2016

Time: 10:00 – 13:00 Hrs.

Max. Marks: 50

- ✍ **Question no-1 is compulsory.**
- ✍ **Answer any THREE from remaining four questions.**

1. Draw one point perspective view of Kitchen. As shown in the figure (q1).  
P.P to observer is 10cm, ground line to horizon line is eyelevel I,e 4.5cm. Draw the view.  
**SCALE 1:20.**  
**(Do not erase the construction lines, Assume suitable data).**  
(20 marks)
2. A cube of 30 mm resting on HP on one of its faces is 15 mm in front of VP. A section plane parallel to VP, 35 mm in front of it and perpendicular to HP is cutting the cube. Draw the section.  
(3+3+4 = 10 marks)
3. Draw the development of the cylinder of diameter 50 mm and with 65mm height.  
(3+3+4 = 10 marks)
4. Draft the plan, section, 2 elevations and view of the sofa from the given fig(q4).  
(2+2+3+3 = 10 marks)
5. A Cube of 30 mm resting on HP on one its faces is 15mm in front of VP, it is cut by a section plane perpendicular to HP and inclined to VP. Draw the section.  
(3+3+4 = 10 marks)



FIG (Q 1)

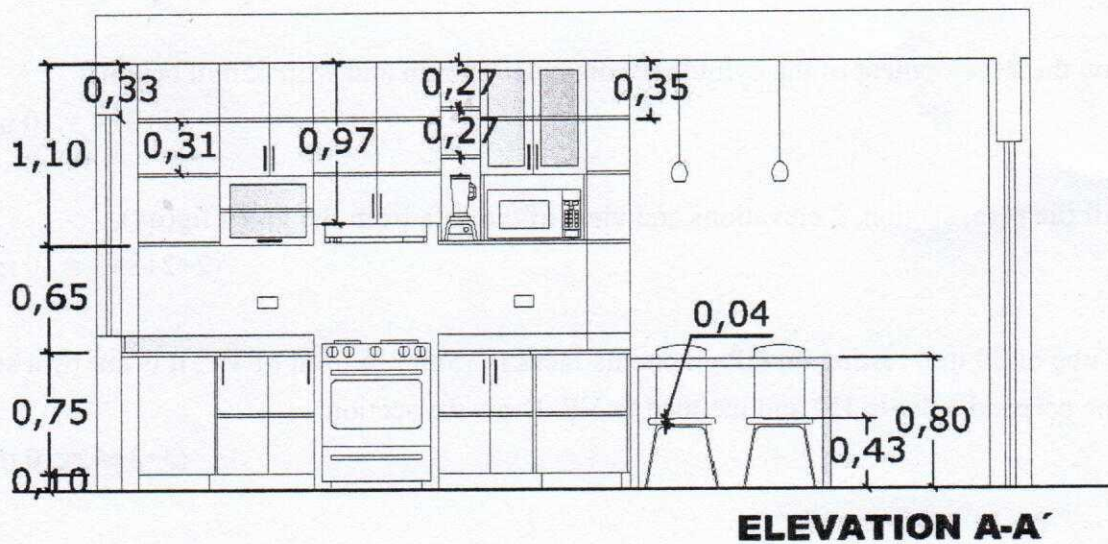
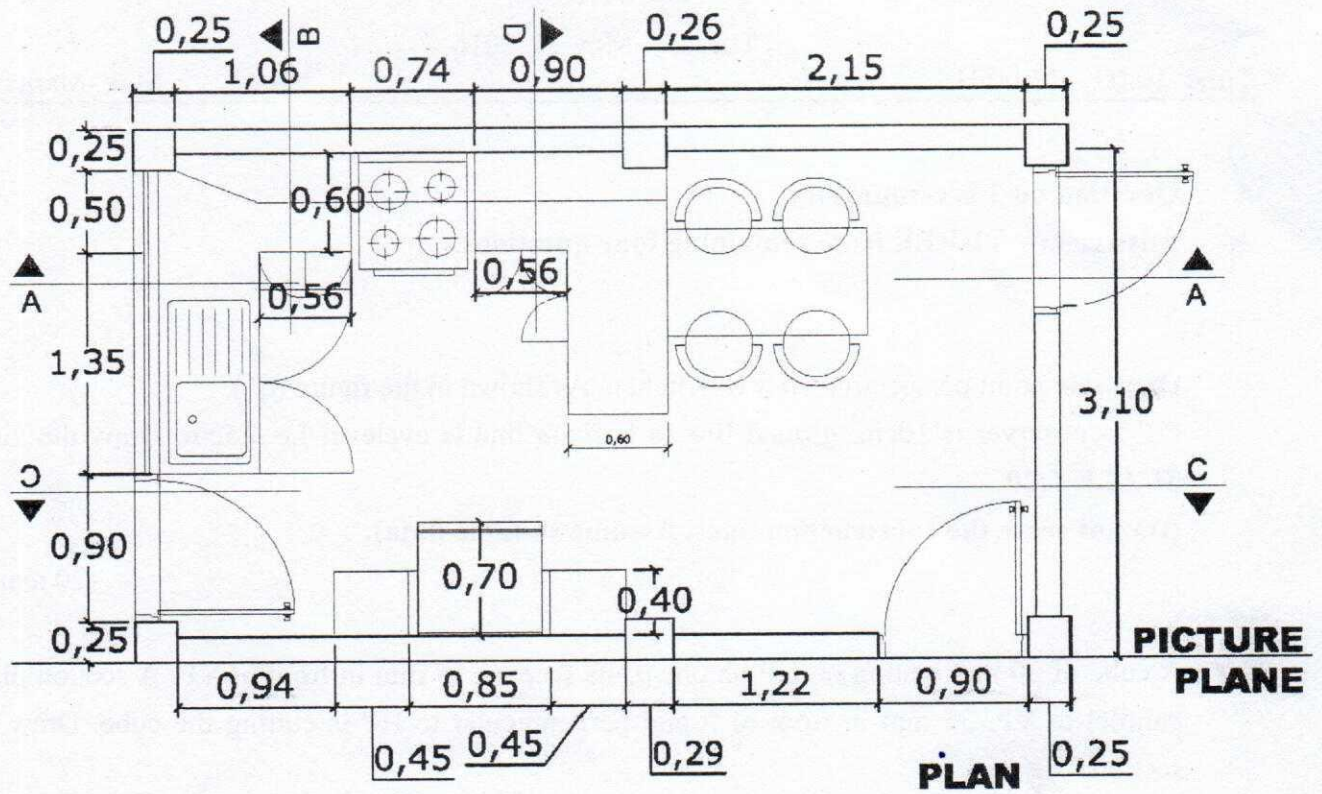
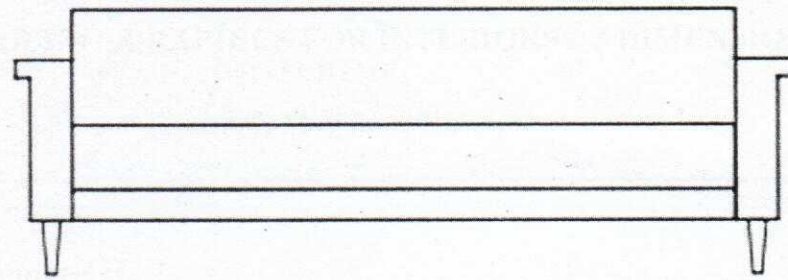



FIG (Q 4)

700 mm



2100 mm

SEAT DEPTH 570 mm

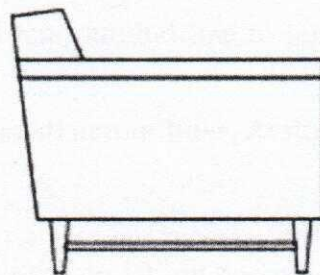

580 mm

830 mm

430 mm

