

MANIPAL ACADEMY OF HIGHER EDUCATION
FIFTH SEMESTER B. ARCH. DEGREE EXAMINATION – NOVEMBER 2018
SUBJECT: ARC-14-301: ARCHITECTURAL DESIGN & DETAILING - V
(2014 SCHEME)

Thursday, November 08; Friday, November 09 and Saturday, November 10, 2018
(Thursday 10:00 – 16:00; Friday (10:00 – 13:00 & 14:00 – 17:00); Saturday (10:00 – 13:00 & 14:00 – 17:00))

Time: 18 Hrs. (in three days)

Max. Marks: 50

- ✗ The first setting of 6 hours is continuous at the end of which the candidate shall submit the drawings as indicated. This submission will not be returned to the candidates, so they are advised to keep a copy of the first day's submission.
- ✗ No sheets will be allowed to be taken out of or into the examination hall.
- ✗ Non-messy snacks are permitted to be taken by students during examination.
- ✗ Answers shall be drawn and written on drawing sheets only.
- ✗ The medium of presentation – pencil, crayon, ink, etc. is left to the choice of the candidate.
- ✗ Assume suitable data wherever not given and state the same with justification.

PUBLIC LIBRARY, MANGALORE

Government of Karnataka envisages the development of a public library in the city of Mangalore. A 21st Century library is a community hub, a workshop filled with tools of knowledge. More than a traditional library it also has to include community functions to attract more people to the library and also impart essential knowledge at the same time. The facility shall be modern in nature, also keeping the ethos of the city intact. Following are the details for the design of the same:

SITE DETAILS:

The site is approximately 2.0 Acre

Permissible F.A.R = 1.5

Maximum Ground Coverage = 50%

Set-backs as per local byelaw: Front setback 10.0 m and other Sides: 5.0 m.

PROJECT REQUIREMENTS:

Built up area (8000 sq. meter)

The area can be flexible up to 10-15%

SPACES:

Entry Lobby, Library, Flexible Exhibition Hall/Area, 200 person Outdoor Auditorium, 4 nos flexible multipurpose rooms, 150 Seats Cafeteria, 5 no Retail Space, 5no Adult Classrooms, 500 Seats Auditorium

Site Plan (Not in scale):

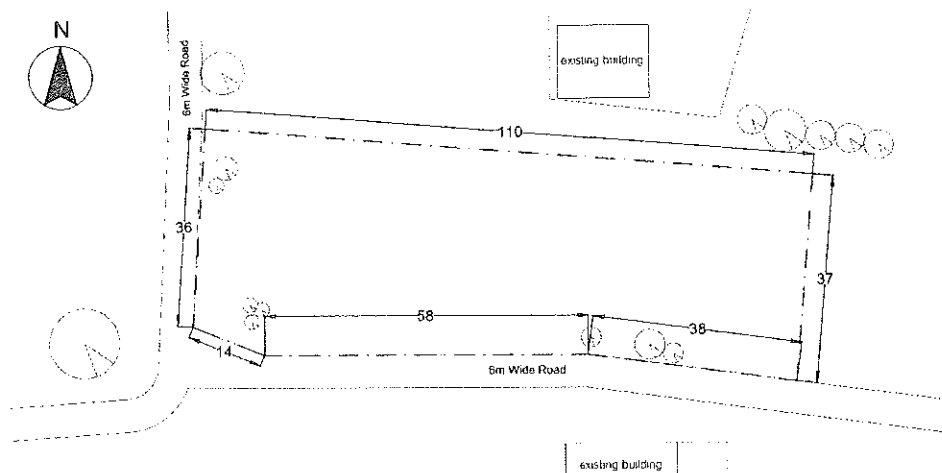

Note:

1. Existing vegetation should be part of design.
2. Design should be barrier free.
3. Design shall be equipped to fulfill the light and ventilation requirements of the spaces with more emphasis on natural features.
4. Block model using thermocol/ivory sheets/white foam sheet shall be made at any of the stages 3, 4, or 5.
5. Assume suitable data wherever necessary.
6. Use of sketches to explain design schemes with reasons.

SUBMISSION REQUIREMENTS:

1. FIRST DAY SUBMISSION

Stage 1: Design Programme:

- i) Users and activities
- ii) Space and area requirement (facilitation, ambience, etc.)
- iii) Design issues
- iv) Design guidelines

(5 marks)

Stage 2: Site Analysis & Zoning:

- i) Context (accessibility, site features, site surroundings, etc.)
- ii) Climate
- iii) Building rules and regulations (if applicable)
- iv) Zoning showing major uses and circulation along with reasoning for the same
- v) Site structure plan
- vi) Bubble diagrams on site, Horizontal and vertical zoning (if applicable)

(10 marks)

Stage 3: Concept Development:

- i) Statement / sketches of concept (related to function, form, structural systems, technologies, materials, environment, aesthetics, philosophy, theme, details, character, heritage, culture, local influences, etc.)
- ii) Sketches showing initial design ideas / experience levels based on the concept
- iii) On site volume/ form development with schematic sections based on function and user experiences, skyline and relationship of built – unbuilt spaces.

(5 marks)

2. FINAL SUBMISSION (DETAILED DESIGN)

Stage 4: Design Development:

- i) Conceptual design(s)
- ii) Finalization of design - Complete with reasons/ logics for design decisions
- iii) Refinement of final design

(5 marks)

Stage 5: Design Scheme:

- i) Master plan with all details (access, road network, circulations, open and built spaces, parking and other important features) - 1: 200
- ii) Floor plans with furniture layout - 1: 100
- iii) Prominent elevation - 1: 100
- iv) Detailed major section - 1: 100
- v) Views

(5+5+2+4+4 = 20 marks)

- 3. BLOCK MODEL** using thermocol/ white ivory card sheets/ white foam sheet shall be made at any of the stages 3, 4, or 5.

(5 marks)

