

Reg. No.

# MANIPAL ACADEMY OF HIGHER EDUCATION

SEVENTH SEMESTER B. DES. (ID) DEGREE EXAMINATION – NOVEMBER 2019

SUBJECT: BID 403.1 – HOSPITALITY INTERIORS  
(2015 SCHEME)

Monday, November 11; Tuesday, November 12 and Wednesday, November 13, 2019  
(Monday 10:00 – 16:00; Tuesday 10:00 – 13:00 & 14:00 – 17:00 and Wednesday 10:00 – 13:00 & 14:00 – 17:00)

Time: 18 Hrs. (in three days)

Max. Marks: 50

## INSTRUCTIONS TO CANDIDATES:

- ✗ The examination is for 6 Hours daily and will be there for 3 days. Students have to submit their concept sheets at the end of day 1 and there will not be any break on day 1.
- ✗ No sheets will be allowed to be taken out of or into the examination hall.
- ✗ Non- messy snacks are permitted to be taken by students during examination.
- ✗ Answers shall be drawn and written on drawing sheets only.
- ✗ The medium of presentation – i.e. pencil, crayon, ink, etc. is left to the choice of the candidate.

## DESIGNING INTERIORS FOR A BOOK CAFÉ

Paper & Cup have approached ID students to redesign their café at End point road, Manipal as a Book Cafe. Design the space that's inviting, comfortable and attractive, yet practical and functional.

### LOCATION CONTEXT

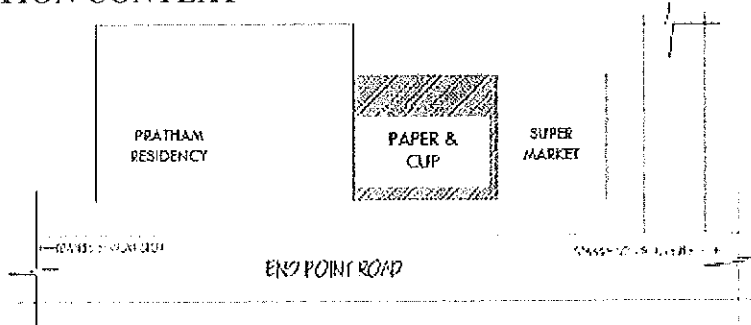

### PLAN

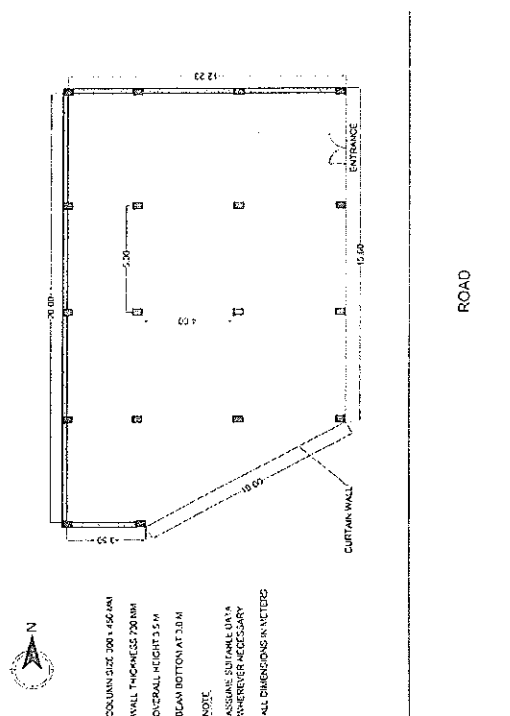

## MINIMUM REQUIREMENTS FOR DESIGNING

- 1) Cash counter
- 2) Waiting Lounge
- 3) Service station, Pantry Desk
- 4) Seating area
- 5) Washroom
- 6) Specify if any other space is essential

## DELIVERABLES

**Note:** Assume suitable data for Menu, Capacity, furniture and material specification (wherever necessary).

Sketches should be neat and proportionate.

### 1) Design Program – Day 1

- a) Identify user and activities
- b) Spaces with areas and furniture Layout (Sketches)
- c) Diagram showing connectivity of spaces
- d) Design consideration for each activity/spaces

(5 marks)

### 2. Concept Development - Day 1

- a) Statement of concept/ theme (related to function, form, technologies, Materials, environment, aesthetics, philosophy, details, character, heritage, Culture, local influences, etc.)
- b) Sketches showing initial designs based on the concept

(10 marks)

### 3. Design Scheme - Day 2 & 3

#### 3A. Floor Plan

The floor plan must be provided with rendered furniture, clearance and its dimension in proportion

(10 marks)

#### 3B. Sectional Elevations

2 major sectional elevations defining your concept with all specifications - dimensions, colours, finishes, materials etc. must be provided in proportion

(10 marks)

#### 3C. Any one View covering majority of the interiors including flooring and ceiling details.

(5 marks)

#### 3D. Proportionate Façade elevation with detailing.

(5 marks)

#### 3E. Sketch (Rendered) any one furniture as per your design with its material specifications and Joinery details.

(5 marks)

